

TECHNICAL DATA

General technical data	VDE 0560 - IEC61071 - EN61071
Application class (DIN 40040)	HSD / LS
Temperature range (Case)	-40 to + 70 °C
Max permissible ambient temperature	+70 °C
Capacitance tolerance code (15 th digit)	J = ± 5% ; K = ± 10%
Test voltage terminal to case U _{TT}	1.5 U _{RMS} for 10 seconds
Test voltage terminal to case U _{TC}	4kV - 50Hz for 60 seconds
Rated insulation voltage U _i	700 V - 50 Hz - Insulation group B (VDE 0110 part 1)
Rated power Q	Reactive power at rated A.C. voltage U _{RMS} - 50Hz
Rated frequency F	50 ÷ 60 Hz
Permissible relative humidity	Annual average ≤ 95% on 30 days / year, continuously 100% on other days occasionally 100%. Dewing not admissible
IEC climatic category	25 / 70 / 21
Degree of protection	IP00
Capacitance deviation in the operating temperature range of -40 to +85 °C	±1.5% max on capacitance value measured at +20 °C
Change of capacitance versus operating time	-3% after 30.000 hours at U _{RMS} or after 100.000 hours at Un
Terminals	Tinned brass fastons or screws (See figure on top)
Installation	Whatever Position
Life Expectancy	≥ 30.000 hours at U _{RMS} ; ≥ 100.000 hours at Un
Failure quota	300 / 10 ⁹ components hour

MECHANICAL CHARACTERISTICS

Case	Brass screw terminals					Bolt
D	W	M	Driving Torque Nm	Creepage Distance	Clearance In air	Driving Torque Nm
76	13	M 6	4	18	22	10
76	25	M 10	7	18	22	10
85	25	M 10	7	22	22	10

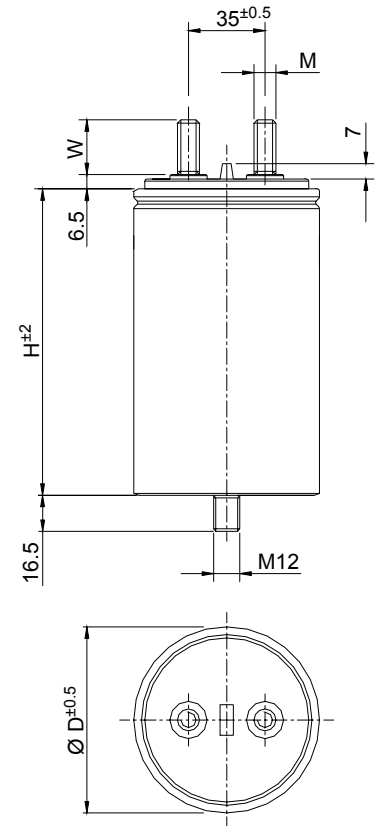

PEAK VOLTAGE TABLE

Un Vdc	U _{PK} Vdc	U _{RMS} Vac
400	600	250
600	800	380
750	1000	440
1200	1600	550

GENERAL CHARACTERISTICS

Code	C	Q	Un	U _{RMS}	dv/dt	I _{PKR}	I _{RMS}	Case Dimensions		Appr. Weight kg
	μF	kvar	Vdc	Vac	V/ μs	A	A	D	H	
C44EFGP6150ZA0J	150	2.95	400	250	10	1500	30	76	138	0.63
C44EFGR6200ZA0J	200	3.93	400	250	10	2000	30	85	137	0.75
C44EFGR6250ZA0J	250	4.9	400	250	10	2500	60	85	185	1.05
C44EFGR6300ZA0J	300	5.89	400	250	10	3000	60	85	230	1.35
C44EFGR6400ZA0J	400	7.85	400	250	10	4000	60	85	270	1.71
C44EHGP6100ZA0J	100	4.53	600	380	20	2000	30	76	138	0.63
C44EHGR6150ZA0J	150	6.8	600	380	20	3000	60	85	200	1.15
C44EHGR6200ZA0J	200	9.07	600	380	20	4000	60	85	260	1.5
C44EKGR6100ZA0J	100	6.08	750	440	20	2000	60	85	185	1.05
C44EKGR6120ZA0J	120	7.3	750	440	20	2400	60	85	200	1.15
C44EPGR5500ZA0J	50	4.75	1200	550	30	1500	60	85	260	1.5
C44EPGR5600ZA0J	60	5.7	1200	550	30	1800	60	85	260	1.5