

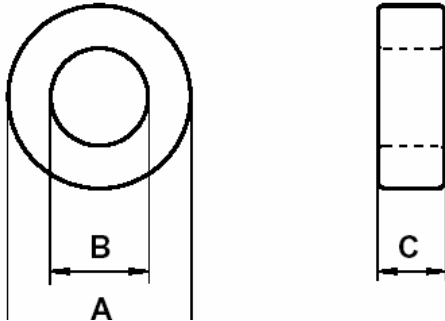

**0077930A7**

110 Delta Drive  
 Pittsburgh, PA 15238  
 Phone: 412/696-1333  
 Fax: 412/696-0333  
 Email:magnetics@spang.com



**Core Markings**

XXXXXX lot number  
 77930A7 part number  
 X inductance

DIMENSIONS		
(mm)	Uncoated	Coated
O.D. (A)	26.9	27.7
I.D. (B)	14.7	14.10
Ht. (C)	11.2	11.94

PHYSICAL CHARACTERISTICS					
W <sub>A</sub> Window Area	A <sub>e</sub> Cross Section	L <sub>e</sub> Path Length	V <sub>e</sub> Volume	Weight	Box Quantity
156.0 mm <sup>2</sup>	65.4 mm <sup>2</sup>	63.5 mm	4,150 mm <sup>3</sup>	25.5 grams	400 pieces

Typical AL Values Core: 0077930A7

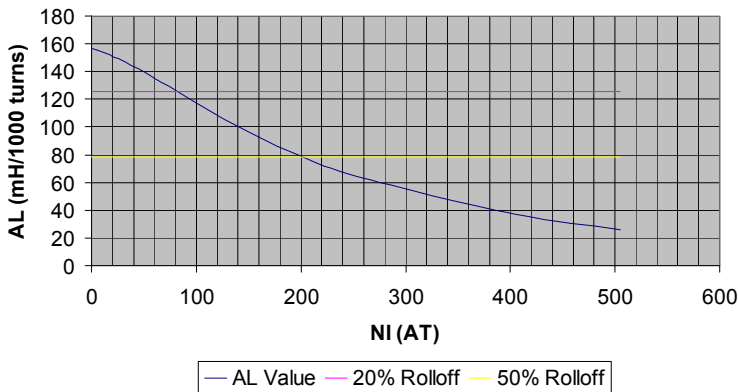

Permeability ( $\mu$ )      **125**

A<sub>L</sub> ± 8%                      **57**

Winding Turn Length	
Winding Factor	Length/Turn (cm)
100% (Unity)	5.23
60%	4.66
40%	4.10
20%	3.85
0%	3.76

Wound Coil Dimensions	
Maximum O.D. (u.w.f.)*	37.3 mm
Maximum HT. (u.w.f.)*	24.0 mm

\*u.w.f. – unity winding factor

Surface Area	
Unwound Core	24.7 cm <sup>2</sup>
40% Winding Factor	33.8 cm <sup>2</sup>

AWG Wire Size	Single Layer Turns	Single Layer Rdc (Ohms, $\Omega$ )	AWG Wire Size	Single Layer Turns	Single Layer Rdc (Ohms, $\Omega$ )
9	11	0.00107	19	42	0.0416
10	13	0.0016	20	47	0.0587
11	15	0.00233	21	53	0.0835
12	17	0.00333	22	60	0.12
13	20	0.00494	23	66	0.165
14	22	0.00685	24	75	0.237
15	25	0.0098	25	84	0.335
16	29	0.0144	26	94	0.476
17	33	0.0203	27	105	0.744
18	37	0.0291	28	117	0.942