

SERIES PPA ATTENUATORS

High Power – DC-4GHz

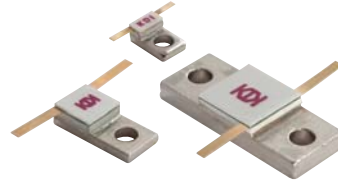

The Aeroflex/KDI PPA Series of attenuators utilize a Beryllium Oxide chip and thin film technology to provide devices which can dissipate up to 100 watts of R.F. power. The PPA series must be thermally bonded to a heat sink, using the mounting holes provided, in order to operate within the temperature rating indicated. The flange temperatures must not exceed 100°C under rated power conditions.



ORDERING INFORMATION

The Power Attenuators listed are available in 1 dB increments from 1 thru 20 dB. Specify by selecting any of the series listed and add the attenuation value desired to the basic series designation. (See note 3)

EXAMPLE:



GENERAL SPECIFICATIONS

| | |
|-----------------------|---|
| Impedance | 50 Ohms |
| Operating Temp. | -55°C to +150°C |
| Attenuation Stability | 0.0001 dB/dB/°C |
| Substrate | Beryllium Oxide Ceramic |
| Resistive Element | Proprietary Thin Film |
| Flange | Copper, Nickel Plated per QQ-N-290 |
| Tabs | Beryllium Copper, Gold Plated per MIL-G-45204 |
| Cover | Alumina Ceramic |

PERFORMANCE SPECIFICATIONS

| Model | Attenuation ⁽¹⁾ 1 dB Increments (dB) | Frequency ⁽¹⁾ Range | Input Power (Watts) | Attenuation Accuracy (1) (dB) | | | VSWR (Typical) ² | |
|---------|---|-----------------------------------|------------------------|----------------------------------|---------------------------------------|------------------------------|--------------------------------|---|
| | | | | dB | DC-1 GHz | 1-2.5 GHz | | 2.5-4 GHz |
| PPA 10 | 1-20 | DC-4 GHz | 10 | 1-10 11-20 | ±0.5 ±1.0 | ±0.5 ±2.0 | ±1.0 ±3.0 | 1.3:1 |
| PPA 20 | 1-20 | DC-4 GHz | 20 | 1-5 6-9 10-15 16-20 | ±0.5 ±0.5 ±0.75 ±1.0 | ±0.5 ±0.5 ±1.0 ±2.0 | ±0.5 ±1.0 ±1.5 ±3.0 | 1.15:1 – DC-1.0 GHz 1.35:1 – 1.0-2.5 GHz 1.50:1 – 2.5-4.0 GHz |
| PPA 50 | 1-20 | DC-1 GHz | 50 | | ±0.3 DC-500 MHz ±0.5 500 MHz-1 GHz | | | 1.25:1 – DC-500 MHz 1.50:1 – 500 MHz-1 GHz |
| PPA 100 | 1-20 | DC-500 MHz | 100 | | ±0.5 | | | 1.25:1 – DC-200 MHz 1.50:1 – 200-500 MHz |

PHYSICAL DIMENSIONS

NOTES

- Custom products are available at higher frequencies with optimized VSWR and attenuation accuracy over narrow frequency bandwidths.
- VSWR as measured in a 0.125" ground plane stripline circuit.
- Standard values 1, 2, 3, 4, 5, 6, 10, 20 dB.
Non-std values available as special order.

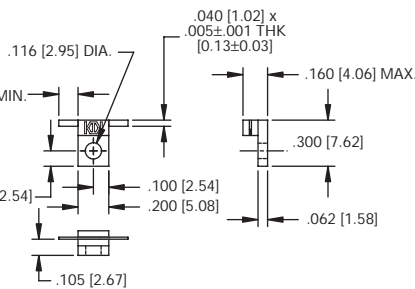

PPA10 OUTLINE

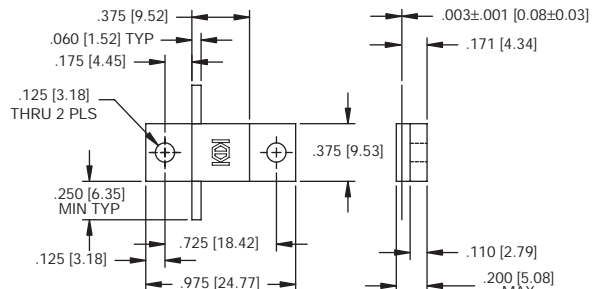

PPA50 OUTLINE

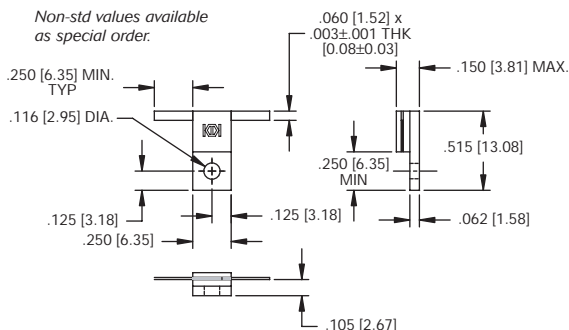

PPA20 OUTLINE

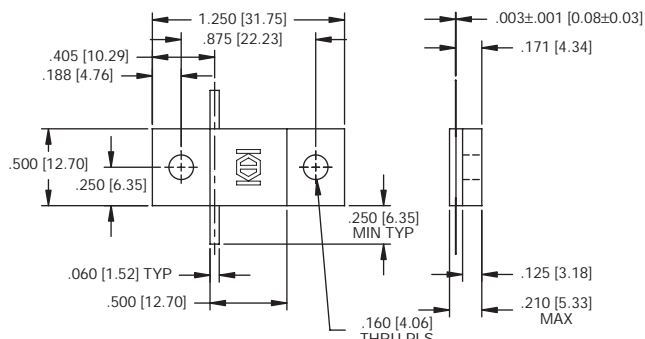

PPA100 OUTLINE

KEY: Inches [Millimeters] .XX ±.03 .XXX ±.010 LX ±0.8 .XX ±0.25J



60 South Jefferson Road, Whippany, NJ 07981
Tel: 973-887-8100 • Fax: 973-884-0445
www.aeroflex-kdi.com • sales@eroflex-kdi.com

